

# Test Insert for Vertical Dewar @DESY



With warm  
finger for  
field  
measuring  
equipment



# Quadrupole Transfer Function on up- and down-ramp of IQ for ID=0,20,40A

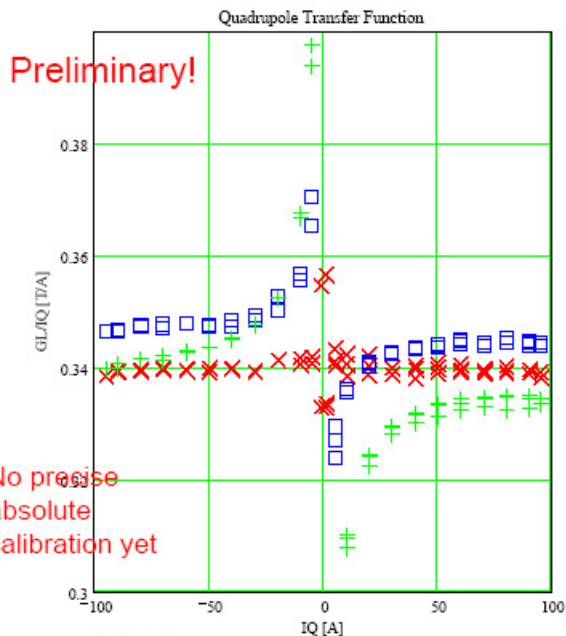

Preliminary!

No precise  
absolute  
calibration yet

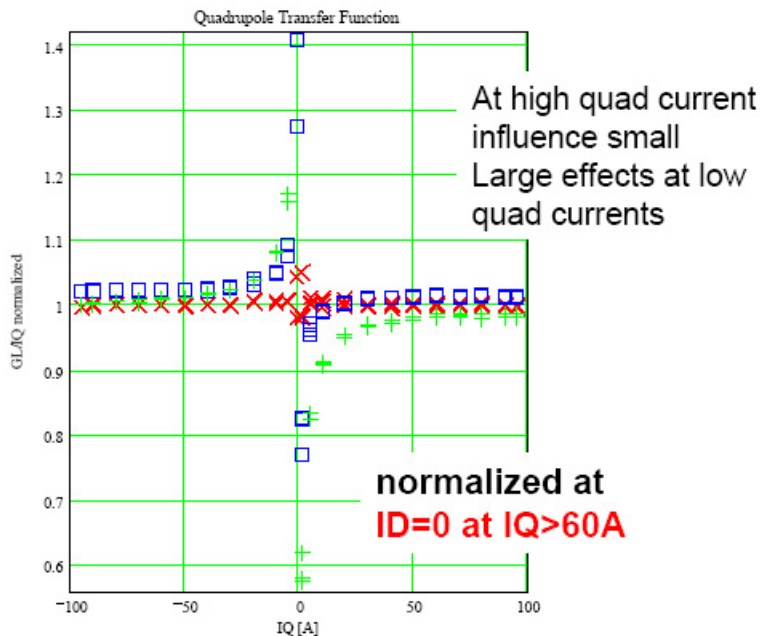

× Red points: ID=0A  
□ Blue Points: ID=20A  
+ Green Points: ID=40A

# Pump Stand **without/with** Modifications

## Vertical Sensors (2 different days)

RMS average, midnight  $\pm$  1 hour

**without**

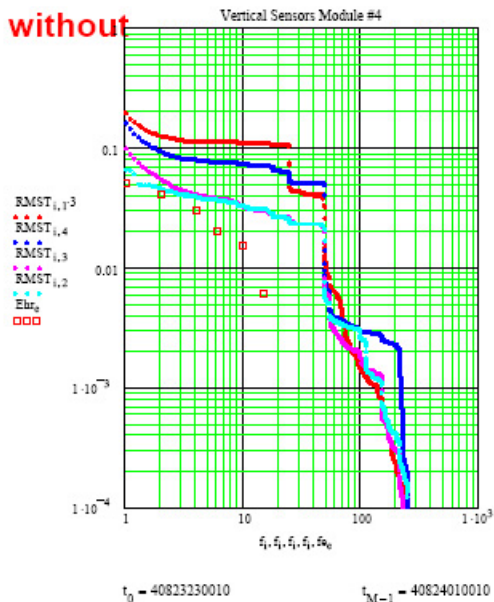

**with**

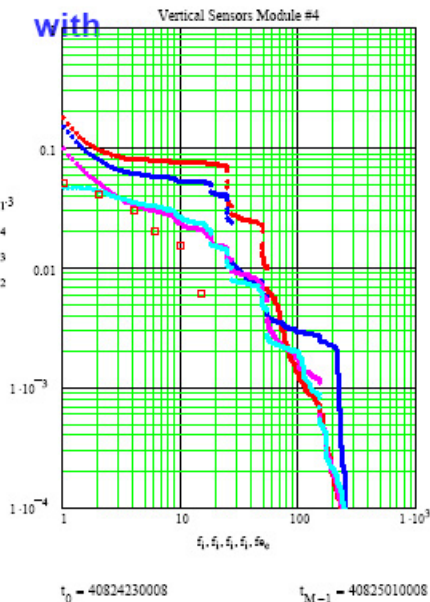

Sensors:

Cold

Top

Socket

Geophone

Socket

■ Different days

□ Mon "without"

□ Tue "with"

■ Cold Signal \*3

■ Some reduction below 25 Hz

■ Large reduction between 25 and 50 Hz



# Cavity BPM For ILC

---

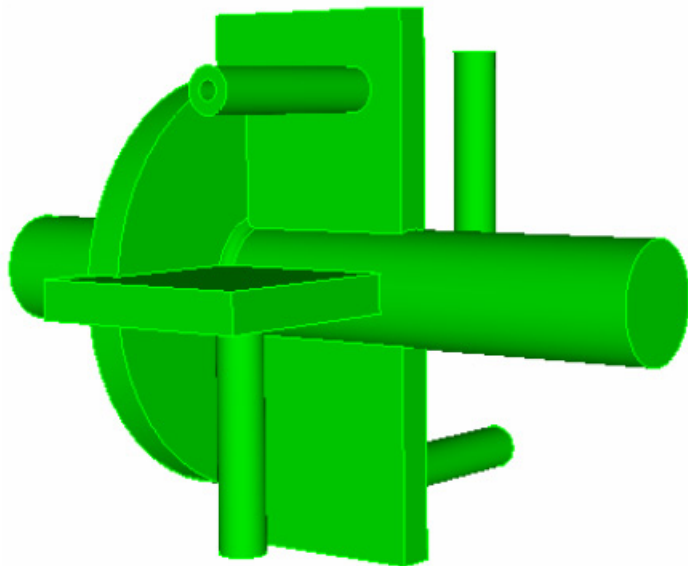

- Need to fit into tight space
- Need to be clean
- Bunch spacing: 300 ns
- Resolution: 1  $\mu\text{m}$
- Single bunch BPM response
- Frequency around 1.5 GHz
- $Q_{\text{load}} < 300$

# Design 18

