



Webex meeting 4 February 2009



Complement to Push-Pull Considerations

A. Hervé / ETHZ@CERN

ILD Detectors

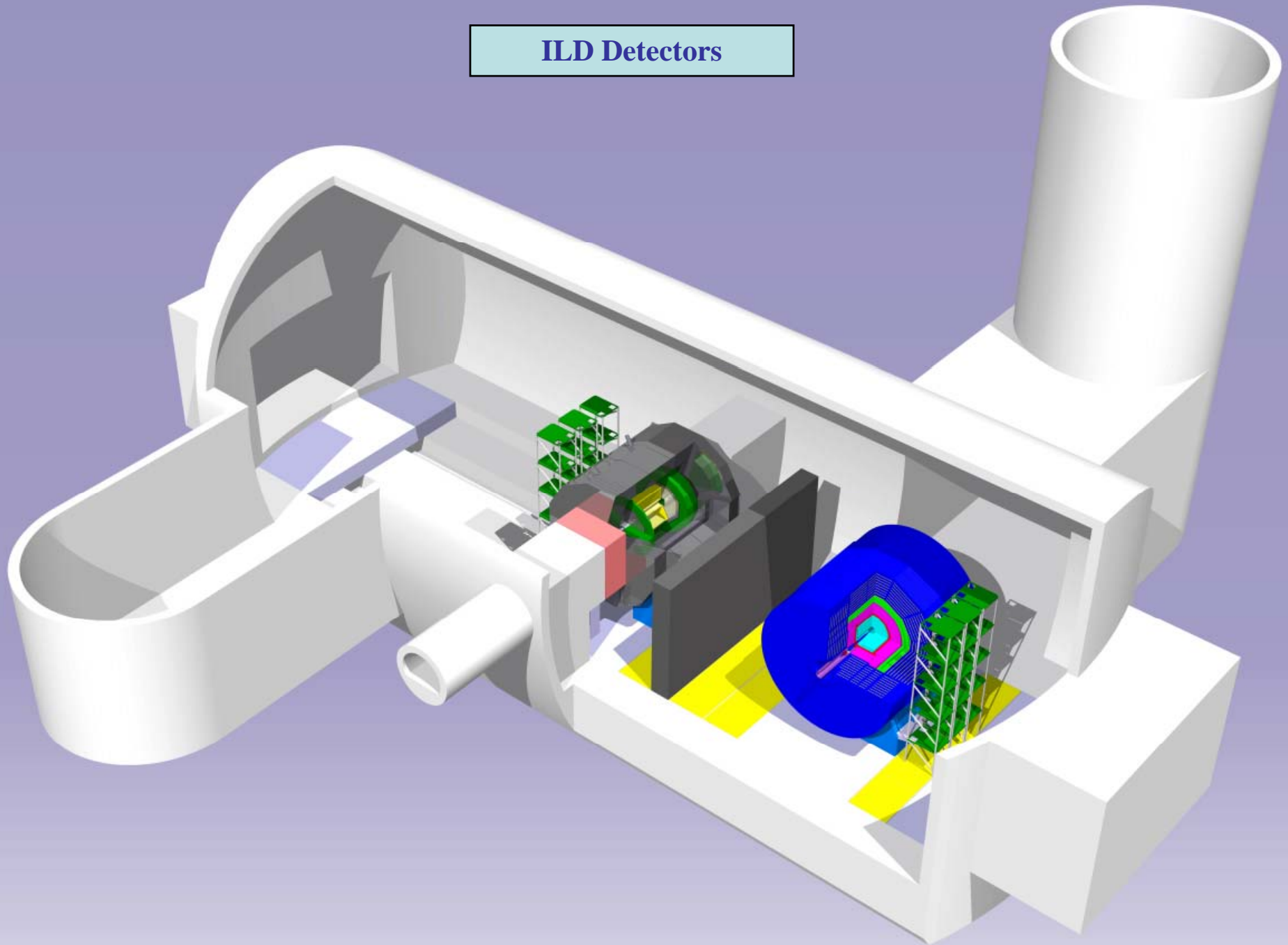

Design N.S. ETH-Z, January 2009.

An effort must be made to reduce the Diameter of the Underground Hall

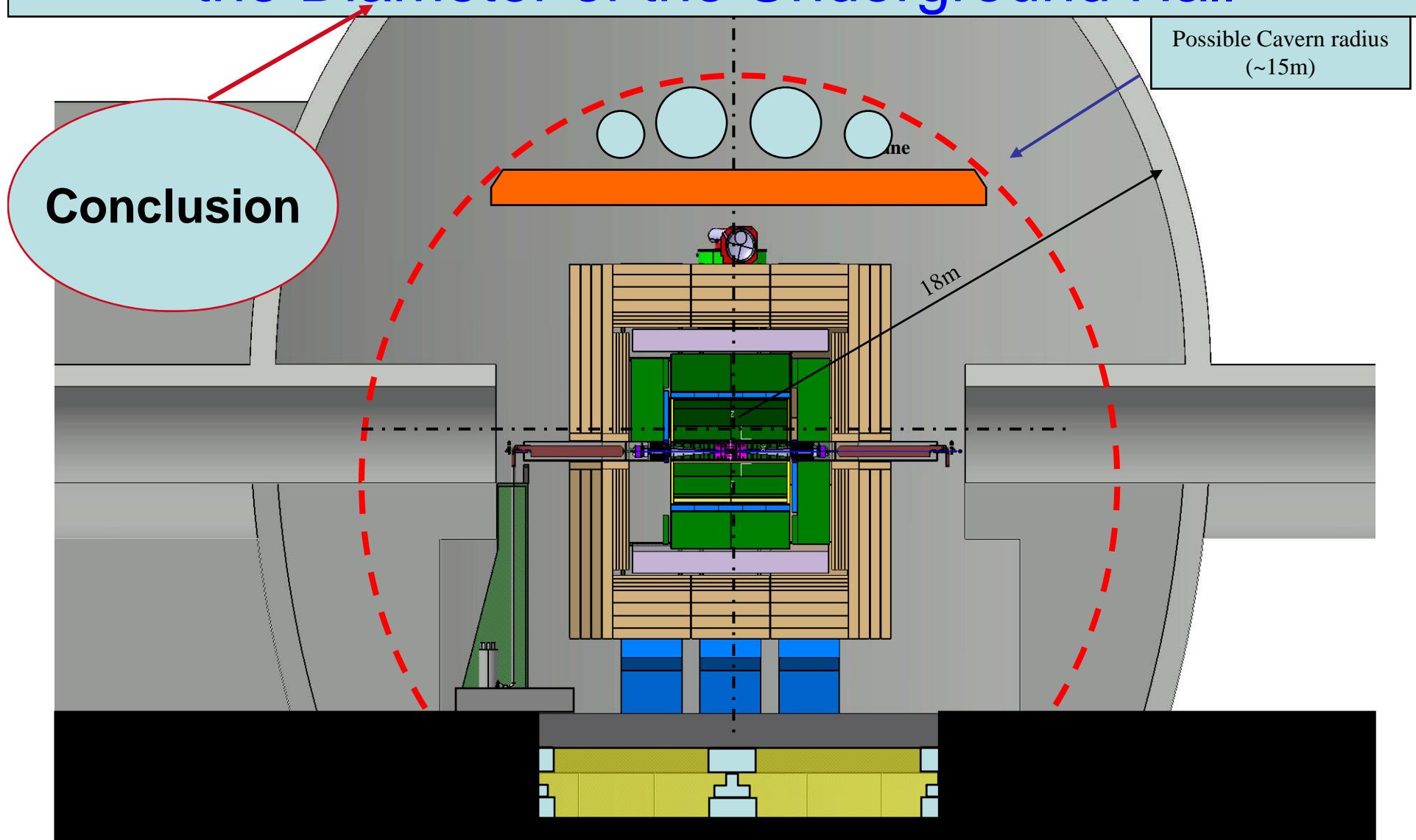

We have played on three parameters using the same dimensions for ILD

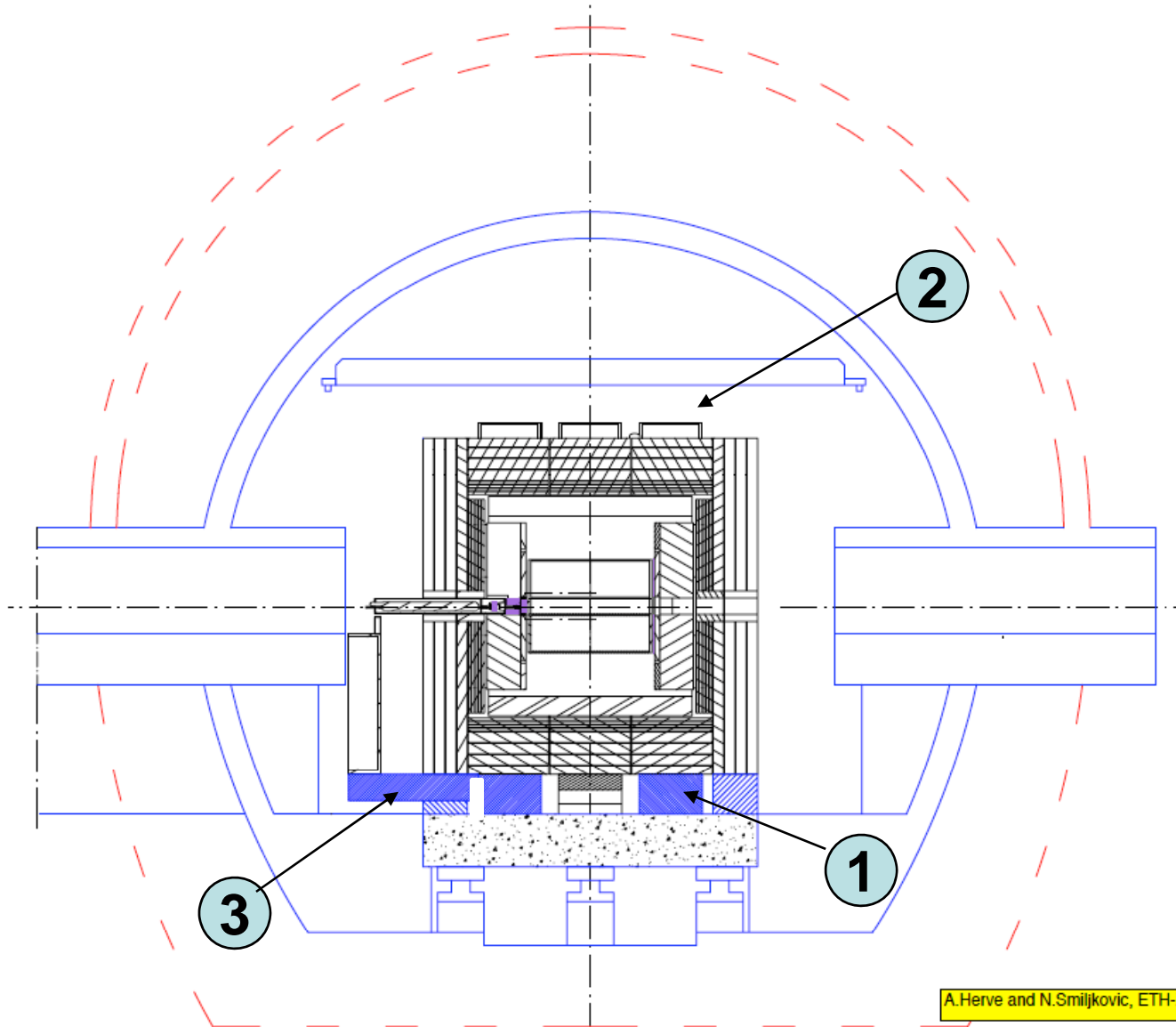



The Pacman structure could be designed to allow sufficient opening on IP

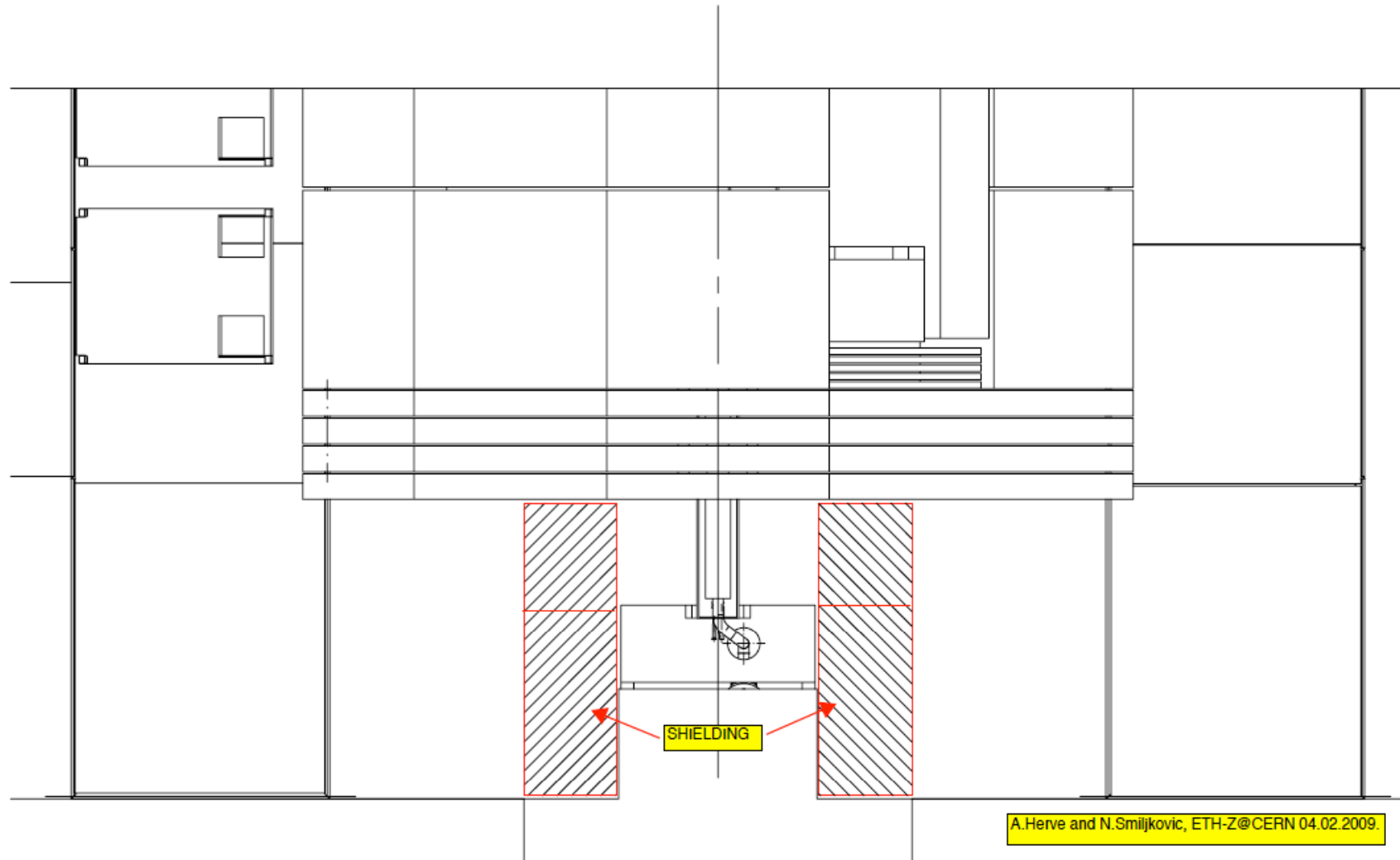



The equivalent drawing must be generated to define the space needed in garage position

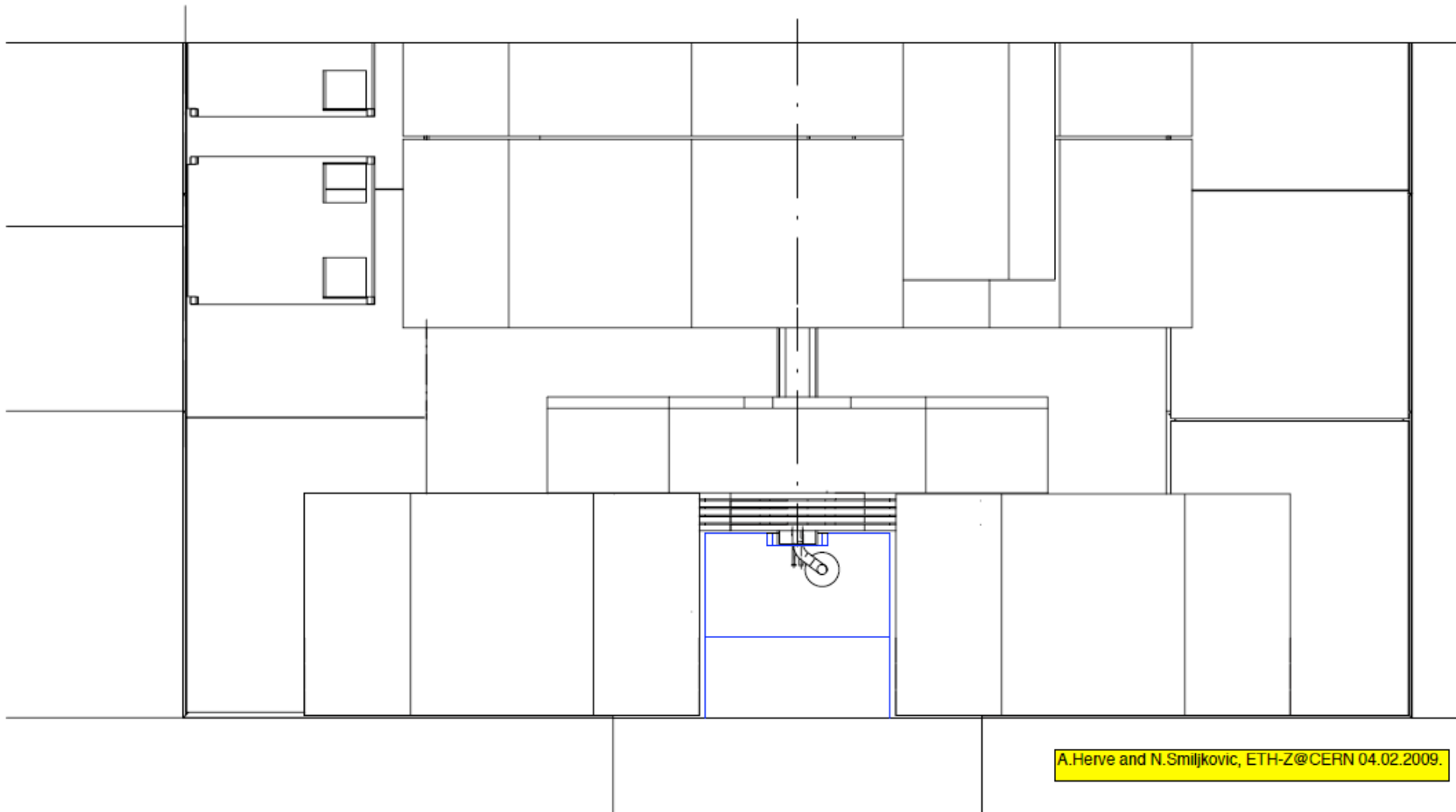

A.Herve and N.Smiljkovic, ETH-Z@CERN 04.02.2009.



Opening position in garage position with a small alcove for Q0 support

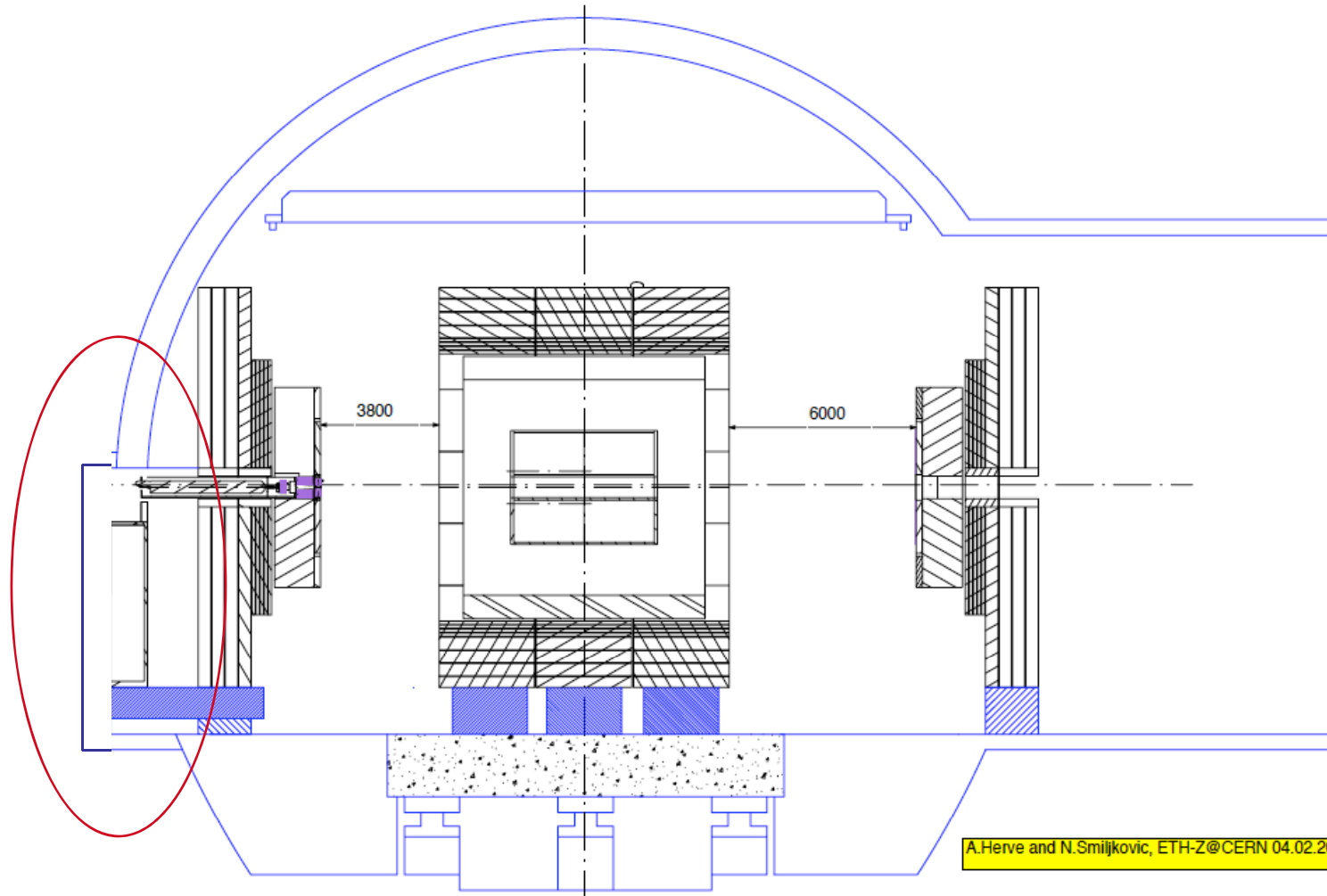



Opening position in garage position with a sliding central barrel

