

BDS Tunnel Configuration

TDR-Baseline

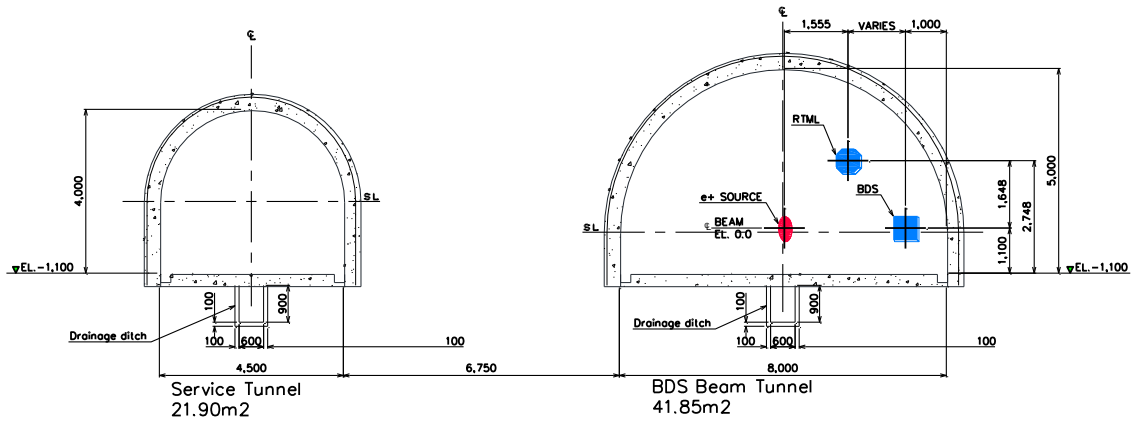

New-Baseline (Tentative)

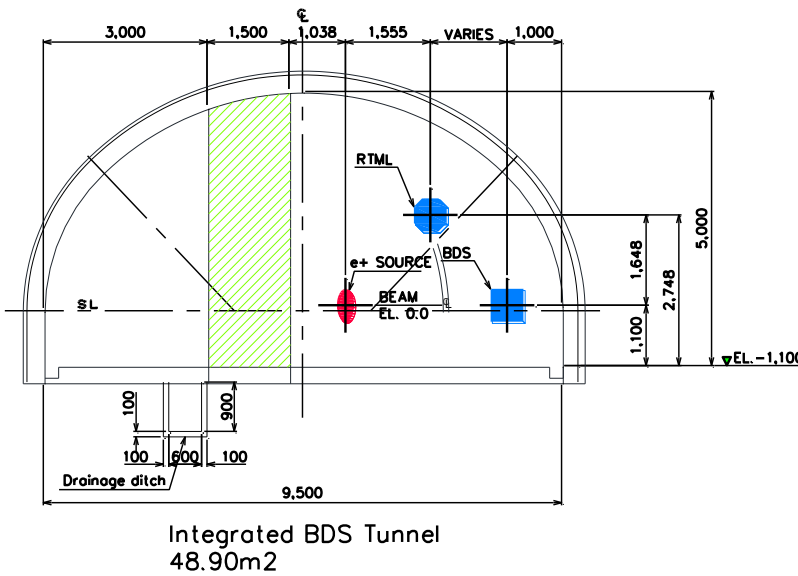

仮定条件：

1. BDS Beam Tunnel: 5.0m
 2. Service Gallery: 3.0m
 3. Shield wall: 1.5m
- Total width: 9.5m

注 1) サービストンネルの与条件が不明であるが、1.5mのシールド壁を前提とする。
 注 2) 実際には標準断面より大きな特殊断面部が数箇所想定されるが、本試算においては
 Baseline でも New Baseline でも同一条件と想定する。

Cost Impact (Rough Estimate)

Direct Cost/Tunnel meter

		Baseline			Integrated Option.		
		Quantities	Unit P. kJPY	Amount kJPY	Quantities	Unit P. kJPY	Amount kJPY
Beam Tunnel	Excavation	41.9 m3/m	8.4	352	48.9 m3/m	8.2	401
	Lining	10.1 m3/m	21.0	212	11.2 m3/m	21.0	234
	Shield W	-	-	-	7.5 m3/m	27.0	203
	Sub total			564			838
Service Tunnel	Excavation	21.9 m3/m	13.0	285	-	-	-
	Lining	7.1 m3/m	22.0	156	-	-	-
	Sub total			441	-	-	-
Total	Direct cost			1,005			838

-168 kJPY /m (Direct Unit Cost difference)

-336 kJPY /m (Total Unit Cost difference)

BDS Tunnel Length

E- : 3,060m

E+: 1,980m Toytal Length: 5,040m

Cost Difference:

5,040m * @336 = 1,693,000 kJPY